

BUILDING
COMMON GROUND



Product List

valid from 1st February 2023



www.maxfrank.com



Spacers

Fibre concrete spacers	12
Cast concrete spacers	24
Plastic spacers	26
Steel spacers	29
Fibre concrete distance tubes	31
Sealing cones and plugs	35
Spacers and distance tubes for drinking water application	41

Formwork technologies

Pecafil® permanent formwork	46
Stremaform® stay-in-place formwork for working joints	51
Stremaform® stay-in-place formwork for expansion joints	64
Tubbox® column former	68
Zemdrain® CPF liner	73
Balcony and ceiling edge formwork	78
Box-out shutters and recess formers	81
Trennfit release agent	85
Formwork accessories	89

Reinforcement technologies

Egcobox® thermal break balcony connector	94
Egcobox® FST steel thermal break connector	101
Egcodorn® shear force dowel	104
Stabox® continuity strip	111
MAX FRANK Coupler threaded connection	117

Sealing technologies

Zemseal® sub-structure waterproofing system	124
Fradiflex® metal waterstop	127
Intec® injection hose system	132
Cresco® expanding waterstop	141

Building acoustics

Sorp 10® room-acoustic sound absorber	146
Egcopal impact sound insulated shear force dowel	148
Egcosono stair landing bearing	152
Egcostep® stair flight decoupling	155
Egcoscal stair beddings	157
Egcodist wall and floor bearings	161
Egcovoid® void former	163



**BUILDING
COMMON GROUND**



OUR BUSINESS MODEL



We accompany our customers reliably through every building phase with a technically sophisticated and intensive intermeshing of industrial production, high-quality products and multifaceted services.

HOW WE WORK



We listen attentively and ask the right questions – questions that penetrate to the core of the task. We at MAX FRANK call that: “BUILDING COMMON GROUND”.

OUR STRENGTH



A wide range of products, high-quality product combinations, project solutions, intermeshing of planning, production and sales

CUSTOMER BENEFITS



Saving of costs and time, solution from a single source

THE COMMON APPROACH



Sustainable and safe reinforced concrete structures



MAX FRANK Group

- News
- Projects
- Company
- Careers
- Contact
- Buildings
- Products
- Service
- Download

Product Overview



Products

With a reference search you can pinpoint the exact MAX FRANK product for your solution even faster and more precisely: simple filtering and targeted searches.

Joint

Choose joint

Thermal insulation

Expanded polystyrene concrete quality

Reset filter

Save search

Formwork

Choose formwork

Sound insulation

Precast element

Sealing

Sealing with concreting

Fire protection

Force transfer

10 results found!



Continuity Strip Stabox - special coating



Continuity Strip Stabox - custom version SD



Continuity Strip Stabox - joint seal



Formwork elements for controlled crack joints Stremaforme with rubber water bar cage



Formwork elements for controlled crack joints Stremaforme with coated metal water stop



Formwork elements for expansion joints Stremaforme with rubber water bar cage and shear force transmission



Formwork elements for working joints Stremaforme - custom shapes



Formwork elements for working joints Stremaforme with rubber water bar cage



Formwork elements for working joints Stremaforme with metal water stop



Formwork elements for working joints Stremaforme with coated metal water stop

Follow us on



BUILDING
COMMON GROUND



MAX FRANK BUILDINGS

The popular tool is integrated in the website and linked with extensive product information. The virtual landscape provides you with the optimal products for the following types of structure: railway station, bridge, office building, high-rise building, industrial building, sewage plant, museum, drinking water tank, tunnel, hydroelectric power station and residential building.



PRODUCT FINDER

Simply filter by the application areas and product properties relevant for you and you will find the ideal product for your requirements.



Joint Designer

The joint designer shows the range of connection joints in concrete structures according to the classification between construction joints, predetermined crack joints, expansion joints, sound separation joints and settlement joints.



ALWAYS UP TO DATE

Never miss out! We keep you updated about new products, the latest software and special solutions. Simply sign up for our newsletter free of charge and without obligation and follow us on LinkedIn and YouTube!



ONLINE CATALOGUE

You can find current product and price information in our online catalogue.

Also use functions such as the product comparison, the watch list or the PDF download of article information.



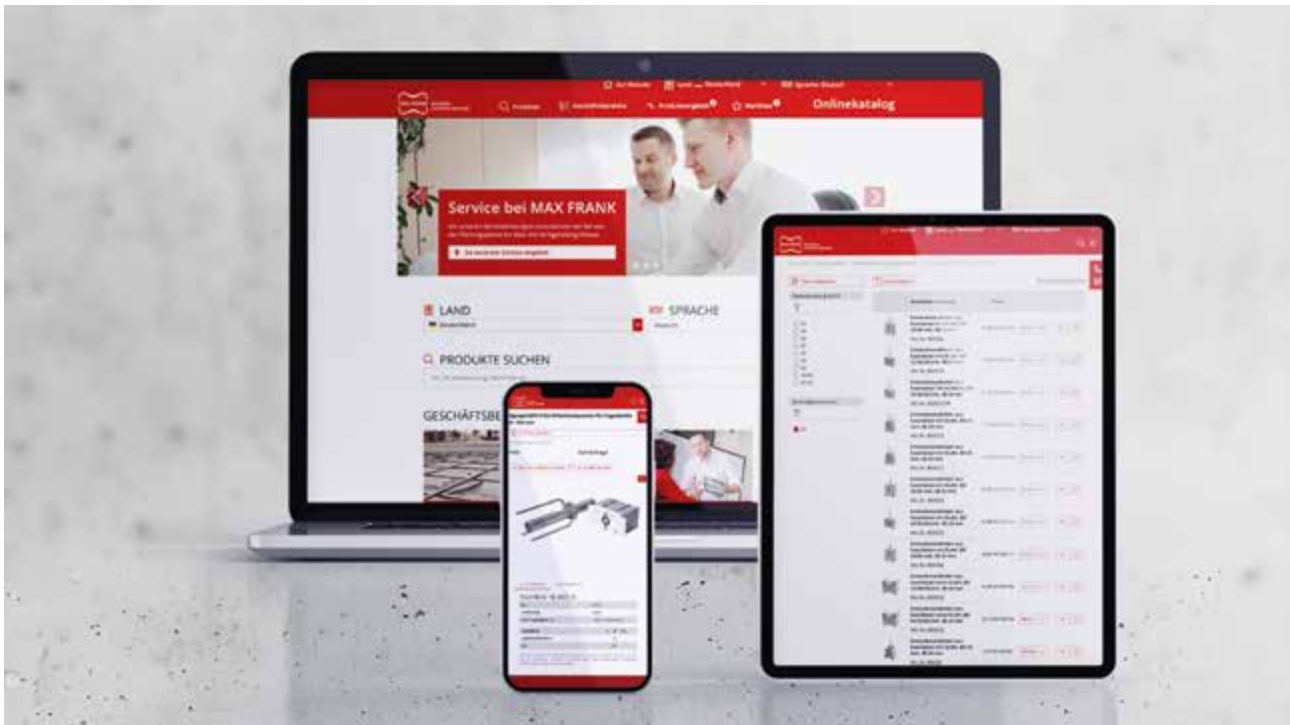

Online catalogue

Search, find and compare MAX FRANK articles.

From now on, this can be done easily online - with the new **online catalogue**.

In the online catalogue you will find a variety of product information, such as article numbers, pictures, descriptions, technical and logistics data and current prices.



Practical features:

Search and filter

With search and filter options you can quickly find the desired items.

Product comparison

Select up to ten items and compare their features at a glance.

Watchlist

Easily start a quote request for the items on the watch list.

Data sheet download

Create a PDF with the most important product information with just one click.

▶ Try the online catalog now



Service at MAX FRANK is multifaceted and therefore very personal.

With our services, we support you from the planning phase to beyond completion and create individual, holistic and economical project solutions together with you.

Our customer service team will be happy to advise you and is available Monday to Thursday from 7:30 a.m. to 5:00 p.m. and Fridays from 7:30 a.m. to 1:30 p.m.:



+49 9427 189-320



customerservice@maxfrank.de

Notes regarding the Product List

We generally deliver on the basis of our general terms and conditions of sale and in the defined packaging units. Information about this can be found in the respective product areas. Different delivery quantities are possible on request and by arrangement. We charge a minimum quantity surcharge for these fractional quantities. A freight rate will be charged for shipment.



MAX FRANK

BUILDING
COMMON GROUND

Spacers



Spacers

Spacers are used to ensure compliance of the concrete cover of reinforced concrete structures and components prior to and during the concreting process.



Fibre concrete spacers

12



Cast concrete spacers

24



Plastic spacers

26

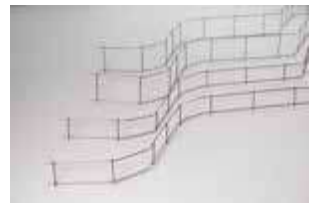

Steel spacers

29



Fibre concrete distance tubes

31



Sealing cones and plugs

35



Spacers and distance tubes for drinking water application

41



Fibre concrete spacers

Achieving the right amount of concrete cover is essential for the durability of reinforced concrete structures. Fibre concrete spacers ensure correct concrete cover before and during concreting. They are characterized by high compressive strength and excellent chemical and physical resistance. A test report according to DBV leaflet "Spacers – edition November 2019" is available from the German concrete association. The spacers fulfil the requirements of all exposure classes. All recipes used are tested by independent testing institutes with regard to the required properties.

★ Advantages

- High density with low porosity
- High load-bearing capacity
- Same material properties as the structural concrete
- Excellent bond with the structural concrete, no hairline cracks
- KOMO certified according to the Dutch assessment guideline BRL2817

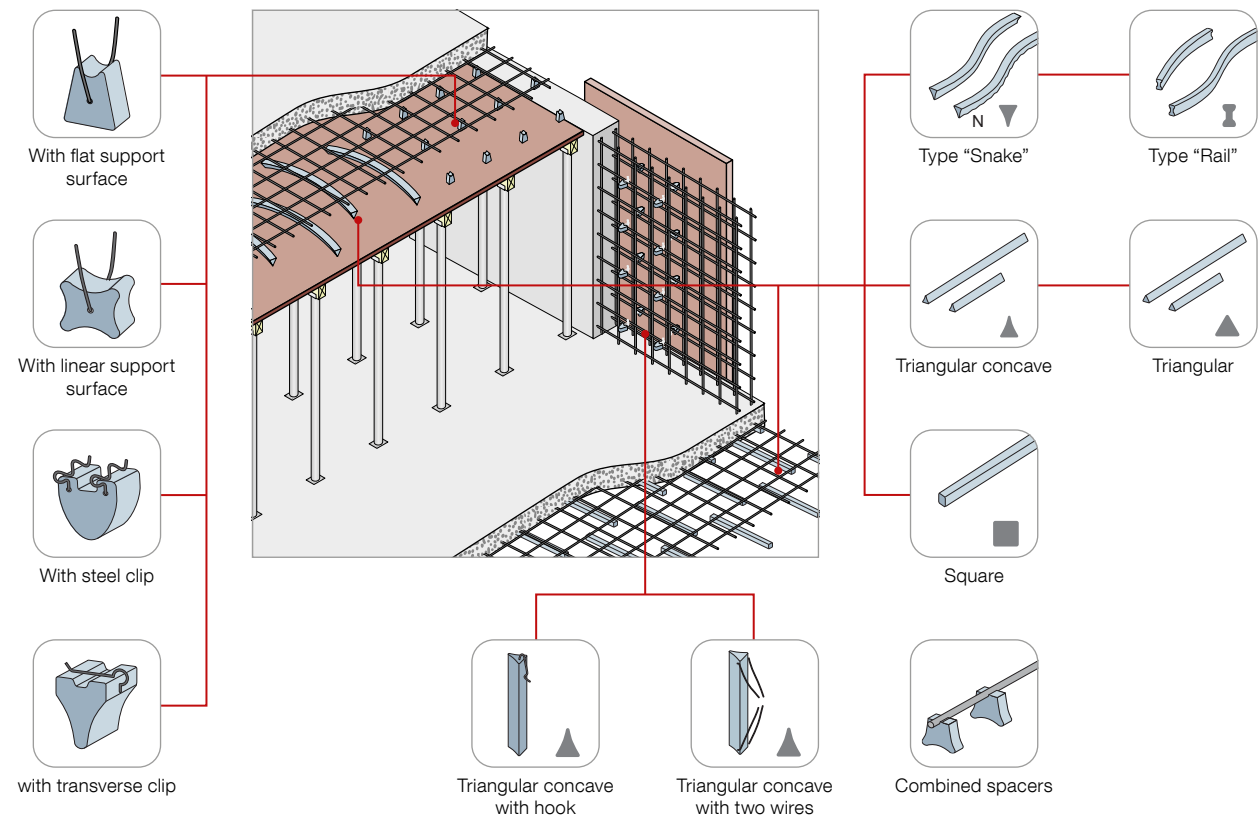

Laying and requirement assessment

In the case of thin main bars, the flexure must be observed during the concreting process. In the case of heavy reinforcement, the compressive stress of the spacers must be checked.

The laying spacing depends primarily on the accepted flexure at the maximum load e.g. when walking on the reinforcement, especially when concreting. When placing bar spacers in the tensile zone, short pieces with a sufficient offset should be installed.

Guiding values according to the DBV data sheet "Concrete cover and reinforcement"

Component: Slabs

Supported main bars \varnothing	max. S	Spacings S of the spacers			
		Block spacers	Requirement, pcs. m ²		
			L = 18 cm	L = 33 cm	L = 1000 cm
< 6,5 mm	0,50 m	4	3,0	2,5	1,33
> 6,5 mm	0,70 m	2	1,6	1,4	0,84

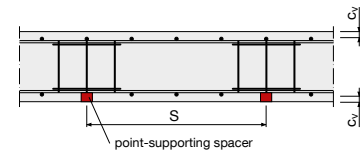

Component: Beams and columns

Spacings S of the spacers max. S ₁ in longitudinal direction		
Longitudinal bars \varnothing	Columns	Beam
< 10 mm	0,50 m	0,25 m
12 – 20 mm	1,00 m	0,50 m
> 20 mm	1,25 m	0,75 m

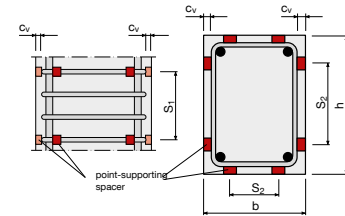

Spacings S of the spacers max. S ₂ in transverse direction		
b / h	Number, distances	
	Columns	Beam
< 1,00 m	2x	2x
> 1,00 m	≥ 3x	≥ 3x
max. S ₂	0,75 m	0,50 m

Component: Walls

Main bars \varnothing	max. S ₁	Spacings S ₁ and number		
		Block spacers	Requirement, pcs. m ² wall*	
			L = 18 cm	L = 33 cm
< 8 mm	0,70 m	4	1,6	1,4
> 10 mm	1,00 m	2	1,0	0,8

* and per wall side

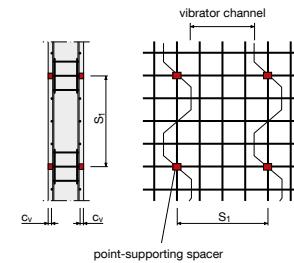

Fibre concrete block spacers

- High compressive strength, no deformation in heat or cold, concrete cover completely maintained
- Secure positioning when closing the formwork and when concreting
- Suitable for impermeable concrete, no hairline cracks between spacer and concrete
- Fire-resistant according to the maximum requirements of DIN 4102 - Class A1 (not flammable)

Type series	AD	AD / BAD	AK	AK-Q	AB	AB
Drawing						
Material quality	Fibre-reinforced concrete	Fibre-reinforced concrete	Fibre-reinforced concrete	Fibre-reinforced concrete	Cast concrete	Cast concrete
Fixing method	Wire	Wire	Double clip	Transverse clip	Shuttlecock clip	Concrete binding wire
Support surface	Flat	linear-supporting	linear-supporting	linear-supporting	point-supporting	Flat
horizontal reinforcement	⊕	⊕	⊖	⊖	⊕	⊕
vertical reinforcement	⊖	⊕	⊕	⊕	⊕	⊕
Exposed concrete	⊖	⊕	⊕	⊕	⊕	⊖
type group	B2	B2	B2	B2	B2	B2

⊕ suitable ⊖ not suitable

Check suitability of spacer on a test surface before use with exposed concrete or self-compacting concrete (SSV).

Type groups according to DBV data sheet "Spacers" are: B1 = point-supporting, not fixed, B2 = point-supporting, fixed, C1 = linear-supporting, not fixed, C2 = linear-supporting, fixed

Spacer with wire

WG: 50

Made of fibre-reinforced concrete for horizontal and vertical reinforcement.

	Item No.	Concrete cover	Cutting width	Packaging unit	Weight	Pallet content	Weight
		mm	mm	Pcs	kg/packaging unit	Pcs	kg/pallet
	BAD25	25	24	600	21.00	24000	860
	BAD30	30	24	600	22.80	24000	932
	BAD35	35	24	500	23.50	20000	960
	BAD40	40	24	400	23.80	16000	972
	BAD50	50	24	250	19.50	10000	800
	BAD60	60	24	250	23.75	10000	970
	AD4012	40	24	250	20.75	10000	850
	AD4512	45	24	250	22.00	10000	900
	AD5013	50	28	200	24.00	8000	980
	AD5513	55	28	175	23.45	7000	958
	AD6013	60	28	175	25.38	7000	1035
	AD3562	35/40	24	250	17.50	10000	720
	AD4562	45/55	24	200	23.40	8000	956
	AD5062	50/60	24	200	24.60	8000	1004
	AD2071	20/25/30	20	750	21.75	30000	890
	AD3572	35/40/50	24	250	24.00	10000	980
	AD4572	45/55/60	24	125	19.13	5000	785

Spacer without wire

WG: 50

Made of fibre-reinforced concrete for horizontal reinforcement.

	Item No.	Concrete cover mm	Cutting width mm	Packaging unit Pcs	Weight kg/packaging unit	Pallet content Pcs	Weight kg/pallet
	BAO25	25	24	600	19.80	24000	812
	BAO30	30	24	600	21.60	24000	884
	BAO35	35	24	500	22.50	20000	920
	BAO40	40	24	400	22.72	16000	929
	BAO50	50	24	250	18.75	10000	770
	AO2071	20/25/30	20	750	21.00	30000	860
	AO3572	35/40/50	24	250	23.25	10000	950
	AO4572	45/55/60	24	125	18.75	5000	770
	AO5013	50	28	200	23.20	8000	948
	AO5513	55	28	175	22.93	7000	937
	AO6013	60	28	175	25.03	7000	1021

Spacers with steel clip

WG: 50

Made of fibre-reinforced concrete for vertical reinforcement.

	Description	Item No.	Concrete cover mm	Cutting width mm	Packaging unit Pcs	Pallet content Pcs	Weight kg/pallet
	Clamp for steel up to 8 mm in diameter	AK25RA	25	20	1000	40000	980
		AK30RA	30	20	750	30000	890
		AK35RA	35	20	500	20000	720

Spacers with transverse clip

WG: 50

Made of fibre-reinforced concrete for vertical reinforcement.

	Description	Item No.	Concrete cover mm	Cutting width mm	Packaging unit Pcs	Pallet content Pcs	Weight kg/pallet
	Groove for steel diameter 3 - 10 mm for external reinforcement	AK30S5Q10	30	36	250	10000	720
		AK35S5Q10	35	36	250	10000	790
		AK40S6Q10	40	36	250	10000	930
	Groove for steel diameter 12 - 16 mm for internal reinforcement	AK30S5Q16	30	36	250	10000	720
		AK35S5Q16	35	36	250	10000	830
		AK40S6Q16	40	36	250	10000	920

“Rondo” round spacer

WG: 50

Round spacer made of fibre-reinforced concrete for wrapping prefabricated reinforcement cages in formwork. When using Tubbox® column formers, the round spacer simplifies the insertion of the reinforcement cage. For steel diameters up to 12 mm.

	Item No.	Concrete cover mm	Cutting width mm	Packaging unit Pcs	Weight kg/packaging unit	Pallet content Pcs	Weight kg/pallet
	RONDO03002512	30	25	110	23.98	4400	979
	RONDO03502512	35	25	100	25.50	4000	1040
	RONDO04002512	40	25	60	20.52	2400	841
	RONDO05002512	50	25	40	24.08	1600	983

Pile cage spacers "AROLLE"



WG: 50

Round spacers attached to horizontal reinforcement allow the reinforcement to formally enter the drill hole. For steel diameters up to 12 mm (hole diameter 15 mm).

	Item No.	Concrete cover mm	Cutting width mm	Packaging unit Pcs	Weight kg/packaging unit	Pallet content Pcs	Weight kg/pallet
		AR0208515	35	20	100	24.00	4000
	AR02010515	45	20	50	17.30	2500	885

Binding wire

WG: 180

	Description	Item No.	Wire thickness mm	Weight kg/packaging unit	Pallet content Packaging unit	Weight kg/pallet
	Binding wire roll BR 1.4 black toughened	HSBDRS14	1.4	20.00	36	740
	Binding wire roll BR 1.4 galvanized	HSBDRV14	1.4	20.00	36	740

Fibre concrete bar spacers

- High compressive strength, no deformation in heat or cold, concrete cover completely maintained
- Suitable for impermeable concrete, no hairline cracks between spacer and concrete
- Large support surface - no impressions in the formwork
- Fire-resistant according to the maximum requirements of DIN 4102 - Class A1 (not flammable)
- All bar spacers from a length of 330 mm are provided with an interior reinforcement fibre for high protection against breakage

	Snake, Snake N, Banana N	Rail, Rail B	Triangular	Triangular concave	Triangular concave with hook	Triangular concave with binding wire	Square	Round	Combined spacers
Type series	FAHKS FAHKBN	FAHSS FAHSB	FAHD	FAHK	FAHDH	FAHKZD	FAHV	FAHR	KOMBST
Drawing									
horizontal reinforcement	+	+	+	+	-	○	+	+	+
vertical reinforcement	-	-	-	-	+	+	-	-	-
Exposed concrete	○	-	-	-	○	○	-	○	+
type group	C1	C1	C1	C1	C2	C2	C1	C1	B1 / C1

⊕ suitable ○ conditionally suitable ⊖ not suitable

Check suitability of spacer on a test surface before use with exposed concrete or self-compacting concrete (SSV).

Type groups according to DBV data sheet "Spacers" are: B1 = point-supporting, not fixed, B2 = point-supporting, fixed, C1 = linear-supporting, not fixed, C2 = linear-supporting, fixed

Bar spacer type "Snake"

WG: 54

Made of fibre-reinforced concrete for horizontal mesh and rod reinforcement.

	Item No.	Concrete cover mm	Length mm	Weight kg/pce	Pallet content Pcs	Weight kg/pallet
	FAHKS20100	20	1000	0.54	1250	695
	FAHKS25100	25	1000	0.70	1000	720
	FAHKS30100	30	1000	0.81	1000	830
	FAHKS35100	35	1000	1.03	750	792
	FAHKS40100	40	1000	1.27	600	782
	FAHKS45100	45	1000	1.41	500	725
	FAHKS50100	50	1000	1.74	500	890
	FAHKS55100	55	1000	1.92	400	788
	FAHKS60100	60	1000	2.20	350	790
	FAHKS20080	20	800	0.43	1250	558
	FAHKS25080	25	800	0.56	1250	720
	FAHKS30080	30	800	0.64	1250	820
	FAHKS35080	35	800	0.83	1000	852
	FAHKS40080	40	800	1.02	750	785
	FAHKS45080	45	800	1.13	600	698
	FAHKS50080	50	800	1.39	600	854

Lengths can be subject to production-related tolerance.

Bar spacer type "Snake N"

WG: 54

Made of fibre-reinforced concrete with nubs for horizontal mesh and rod reinforcement.

	Item No.	Concrete cover	Length	Weight	Pallet content	Weight
		mm	mm	kg/pce	Pcs	kg/pallet
	FAHKS20100	20	1000	0.57	1250	733
	FAHKS25100	25	1000	0.71	1000	734
	FAHKS30100	30	1000	0.79	1000	810
	FAHKS35100	35	1000	1.07	750	823
	FAHKS40100	40	1000	1.26	600	776
	FAHKS45100	45	1000	1.43	500	735
	FAHKS50100	50	1000	1.71	500	875
	FAHKS55100	55	1000	1.93	400	792
	FAHKS60100	60	1000	2.07	350	745
	FAHKS20080	20	800	0.46	1250	595
	FAHKS25080	25	800	0.54	1250	695
	FAHKS30080	30	800	0.63	1250	808
	FAHKS35080	35	800	0.86	1000	880
	FAHKS40080	40	800	1.01	750	778
	FAHKS45080	45	800	1.14	600	704
	FAHKS50080	50	800	1.36	600	836

Lengths can be subject to production-related tolerance.

Bar spacer type "Banana N"

WG: 54

Made of fibre-reinforced concrete with nubs for horizontal mesh reinforcement.

	Item No.	Concrete cover	Length	Weight	Pallet content	Weight
		mm	mm	kg/pce	Pcs	kg/pallet
	FAHKBN2033	20	330	0.22	4050	915
	FAHKBN2533	25	330	0.27	3375	945
	FAHKBN3033	30	330	0.32	2700	895
	FAHKBN3533	35	330	0.41	2160	910
	FAHKBN4033	40	330	0.49	1890	950
	FAHKBN4533	45	330	0.53	1350	740
	FAHKBN5033	50	330	0.57	1080	640
	FAHKBN2025	20	250	0.17	5400	938
	FAHKBN2525	25	250	0.20	4050	838
	FAHKBN3025	30	250	0.25	3510	880
	FAHKBN3525	35	250	0.31	2970	950
	FAHKBN4025	40	250	0.37	2700	1006
	FAHKBN4525	45	250	0.41	2430	1004
	FAHKBN5025	50	250	0.44	2160	979

Lengths can be subject to production-related tolerance.

Bar spacer type "Rail"

WG: 54

Made of fibre-reinforced concrete for horizontal mesh and rod reinforcement.

	Item No.	Concrete cover	Length	Weight	Pallet content	Weight
		mm	mm	kg/pce	Pcs	kg/pallet
	FAHSS30100	30	1000	0.84	1000	860
	FAHSS35100	35	1000	1.09	750	835
	FAHSS40100	40	1000	1.15	600	710
	FAHSS45100	45	1000	1.45	500	745
	FAHSS50100	50	1000	1.70	500	870
	FAHSS55100	55	1000	2.10	400	860
	FAHSS60100	60	1000	2.43	350	870

Lengths can be subject to production-related tolerance.

Triangular bar spacers

WG: 52

Made of fibre-reinforced concrete for horizontal mesh and rod reinforcement with continuous reinforcement threads.

	Item No.	Concrete cover	Length	Weight	Packaging unit	Pallet content	Weight
		mm	mm	kg/packaging unit	Pcs	Pcs	kg/pallet
	FAHD020100	20	1000	-	-	1500	995
	FAHD025100	25	1000	-	-	1000	1020
	FAHD030100	30	1000	-	-	800	1148
	FAHD035100	35	1000	-	-	600	1172
	FAHD040100	40	1000	-	-	400	1024
	FAHD045100	45	1000	-	-	350	1130
	FAHD050100	50	1000	-	-	300	1181
	FAHD055100	55	1000	-	-	250	1178
	FAHD030033	30	330	35.25	75	2475	1183
	FAHD035033	35	330	37.86	60	1980	1269
	FAHD040033	40	330	41.50	50	1650	1390
	FAHD050033	50	330	42.24	33	1089	1414
	FAHD055033	55	330	38.25	25	825	1282

Lengths can be subject to production-related tolerance.

Triangular concave bar spacers

WG: 52

Made of fibre-reinforced concrete for horizontal mesh and rod reinforcement with continuous reinforcement threads.

	Item No.	Concrete cover	Length	Weight	Pallet content	Weight
		mm	mm	kg/pce	Pcs	kg/pallet
	FAHK025100	25	1000	0.81	1000	830
	FAHK030100	30	1000	1.02	1000	1035
	FAHK035100	35	1000	1.34	750	1025
	FAHK040100	40	1000	1.78	600	1090
	FAHK045100	45	1000	1.96	500	1000
	FAHK050100	50	1000	1.91	500	973
	FAHK055100	55	1000	2.63	400	1070

Lengths can be subject to production-related tolerance.

Triangular concave bar spacers with hook clip

WG: 52

Depending on the distance between the horizontal reinforcement layers. Made of fibre-reinforced concrete for vertical reinforcement.

	Item No.	Concrete cover	Length	Packaging unit	Weight	Pallet content	Weight
		mm	mm	Pcs	kg/packaging unit	Pcs	kg/pallet
	FAHDH20018	20	180	200	25.60	6400	839
	FAHDH25018	25	180	130	24.96	4160	819
	FAHDH30018	30	180	125	24.75	3000	614
	FAHDH35018	35	180	100	25.80	2400	639
	FAHDH40018	40	180	75	19.43	1800	486
	FAHDH45018	45	180	60	22.92	1440	570
	FAHDH50018	50	180	50	22.90	1200	570
	FAHDH55018	55	180	50	24.60	1200	610
	FAHDH60018	60	180	44	25.12	1408	824
	FAHDH20033	20	330	150	34.35	3600	844
	FAHDH25033	25	330	65	23.40	2080	769
	FAHDH30033	30	330	75	26.48	1800	655
	FAHDH35033	35	330	55	24.81	1760	814
	FAHDH40033	40	330	50	26.05	1200	645
	FAHDH45033	45	330	37	25.05	1184	822
	FAHDH50033	50	330	30	24.63	960	808
	FAHDH55033	55	330	28	24.92	896	817
	FAHDH60033	60	330	25	26.05	800	854

Clip type "PL" for steel diameters max. 16 mm.

Lengths can be subject to production-related tolerance.

Square bar spacers

WG: 52

Made of fibre-reinforced concrete for heavy, horizontal reinforcement with continuous reinforcement threads.

	Item No.	Concrete cover	Length	Weight	Pallet content	Weight
		mm	mm	kg/pce	Pcs	kg/pallet
	FAHV025025100	25	1000	1.32	850	1142
	FAHV030030100	30	1000	1.89	600	1154
	FAHV035035100	35	1000	2.58	450	1181
	FAHV040040100	40	1000	3.39	350	1207
	FAHV050050100	50	1000	5.38	200	1096
	FAHV060060100	60	1000	7.71	150	1177

Other dimensions and rectangular profiles available on request.
Lengths can be subject to production-related tolerance.

Combined spacer with structural steel rail

WG: 56

Fibre-reinforced concrete spacer with structural steel rail, suitable for non-walkable reinforcement, especially in precast plants.

	Item No.	Concrete cover	Weight	Pallet content	Weight
		mm	kg/pce	Pcs	kg/pallet
	KOMBST25110	25	0.40	1000	420
	KOMBST30110	30	0.45	1000	470
	KOMBST35110	35	0.51	1000	533
	KOMBST40110	40	0.53	1000	550

Steel bar within tolerance dimension of the concrete cover.
Lengths can be subject to production-related tolerance.
Production length approx. 1100 mm with 6 spacers.

Spacer for special applications

Due to the function and use of a building, spacers often have to meet quality requirements that aren't covered by the standard requirements for spacers. In order to ensure that you always have the correct spacer, we can manufacture special spacers according to your requirements.

- Drinking water compatibility
- Individual installation situations
- Reduced water absorption
- Chloride resistance
- Sulphate resistance
- Exposed concrete application

Formwork kicker made of fibre-reinforced concrete

As a continuous stop spacer between the formwork, square profiles 40 x 40 mm with 2 nail holes.

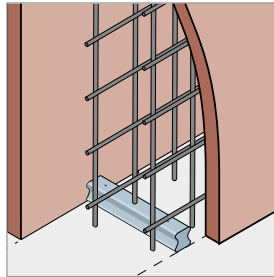

WG: 66

Item No.	Length mm	Packaging unit Pcs	Weight kg/packaging unit	Pallet content Pcs	Weight kg/pallet
SAV400150	150	95	35.63	3420	1303
SAV400200	200	65	32.50	2340	1190

Further dimensions available on request.

Formwork kicker made of fibre-reinforced concrete

As stop spacer between the formwork.

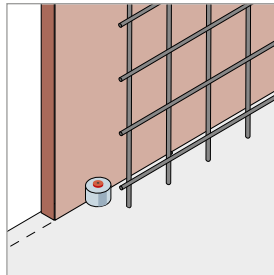

WG: 66

Description	Item No.	Height mm	External diameter mm	Packaging unit Pcs	Pallet content Pcs	Weight kg/packaging unit
With nail insert (without nail)	SAR60N	40	60	100	4000	22.50

When using power-actuated fasteners, it is recommended that you always perform a test assembly to determine the correct cartridge thickness and the correct device setting on site. This can prevent damage to the formwork stops.

Nail for power-actuated fastener

WG: 66

Item No.	Diameter mm	Length mm	Packaging unit Pcs	Weight kg/packaging unit
SAFBRN72	3,7	72	100	1.00

Bar spacer, triangular concave with nubs and two wires, equilateral shape

Made of fibre-reinforced concrete for secure fixing in every installation position with large support width.

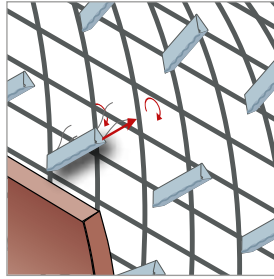

WG: 52

Item No.	Concrete cover mm	Length mm	Weight kg/pce	Pallet content Pcs	Weight kg/pallet
FAHKZDN600220	60	220	0.84	1250	1071
FAHKZDN650220	65	220	0.75	1200	920

Lengths can be subject to production-related tolerance.

Tunnel spacers

In tunnel construction, sealing films are used on the mountain side in the closed tunnel construction method. The large support surface of the tunnel spacers ensures that the spacer has the necessary stability and that the sealing film is not damaged.

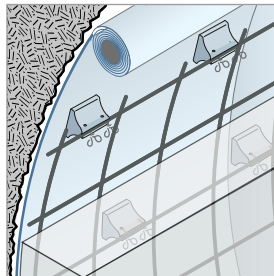

Spacer for fire protection reinforcement

Made of fibre-reinforced concrete for the simultaneous securing of the concrete cover of supporting and fire protection reinforcement for tunnel structures.

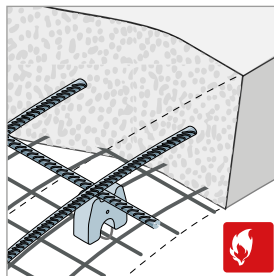

Reinforcement support

Made of fibre-reinforced concrete for supporting rebars. The reinforcement support consists of a fibre-reinforced concrete cylinder and a plastic dowel for fixing the reinforcement. The plastic dowels automatically clamp the reinforcing bars when pushed into the dowels.

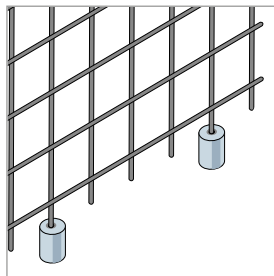



WG: 50

Description	Item No.	Concrete cover mm	Height mm	External diameter mm	Packaging unit Pcs	Weight kg/packaging unit	Weight kg/pallet
Suitable for steel diameter 6 - 10 mm	FBSP53530	30	50	35	250	25.00	1020
	FBSP53535	35	55	35	200	22.00	900
	FBSP53540	40	60	35	200	24.00	980
	FBSP53550	50	70	35	175	24.50	1000

Spacer for concrete pipe production

WG: 50

	Description	Item No.	Concrete cover mm	Cutting width mm	Packaging unit Pcs	Weight kg/packaging unit	Pallet content Pcs	Weight kg/pallet
	Transverse groove for steel diameter 8 mm, clamp for steel diameter 6 mm	AK30Q3K	30	28	250	22.00	10000	900
		AK35Q3K	35	28	250	23.75	10000	970
		AK40Q3K	40	28	200	22.20	8000	908
	Longitudinal groove for steel diameter 6 mm, clamp for steel diameter 8 mm	AK30L10K	30	55	250	18.75	10000	770
		AK35L10K	35	55	250	20.00	10000	820
		AK40L10K	40	55	250	22.50	10000	920

Transverse and longitudinal groove for steel diameter 8 to 10 mm available for all types.

Spacer “shoe shape”

“Shoe-shape” spacers are provided with a nail hole and are suitable for the use of inclined formwork. The spacer can be fixed with a nail and slipping is thus ruled out.

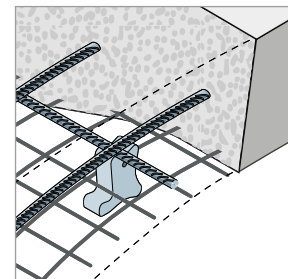

Diaphragm wall spacers

Spacers for diaphragm walls prevent the reinforcement from coming into contact with the building site wall and enable tilt-free lowering of large reinforcement units thanks to the specially shaped profile.

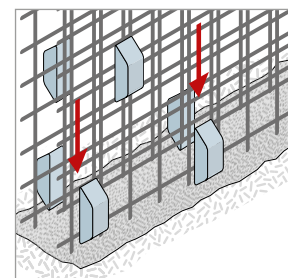



Cast concrete spacers

Cast concrete spacers are used to guarantee concrete cover in case of high requirements for the concrete surface. A test report according to DBV leaflet "Spacers – edition November 2019" is available from the German concrete association.

✚ Advantages

- Cast concrete spacers, no heat/cold deformation
- Absolute guarantee of concrete cover
- Various attachment options for quick and easy fixing
- Precise positioning
- Homogeneous bond, no hairline cracks between spacer and concrete
- Spacers made of cast concrete can be produced in various concrete covers and dimensions.
- Fire-resistant according to the maximum requirements of DIN 4102 – Class A1 (not flammable)



With wire

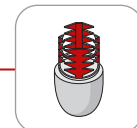
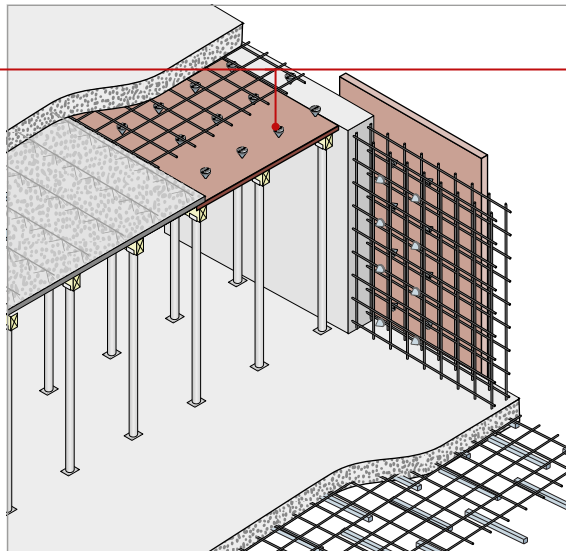

With shuttlecock clip

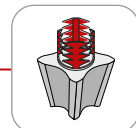

With shuttlecock clip

Spacer with plastic clip



WG: 185

	Description	Item No.	Concrete cover mm	Packaging unit Pcs	Weight kg/packaging unit	Pallet content Pcs	Weight kg/pallet
	For vertical and horizontal reinforcement, clamp for steel diameter 12 mm	AB20HLZ10	20	250	10.25	10000	430
		AB30HLZ10	30	250	12.75	10000	530
		AB40HLZ10	40	250	20.75	10000	850

Further types made of cast concrete available on request.

Spacer with shuttlecock clip

WG: 185

	Description	Item No.	Concrete cover mm	Packaging unit Pcs	Weight kg/packaging unit	Pallet content Pcs	Weight kg/pallet
	For vertical reinforcement, steel diameter 4 - 10 mm	AB25HRF	25	250	8.00	10000	340
		AB30HRF	30	250	9.75	10000	410
		AB35HRF	35	250	12.00	10000	500
		AB40HRF	40	250	13.75	10000	570
	For vertical and horizontal reinforcement, steel diameter 4 - 10 mm	AB25HVF	25	250	11.50	10000	480
		AB30HVF	30	250	14.75	10000	610
		AB35HVF	35	250	17.75	10000	730
		AB40HVF	40	250	20.75	10000	850
		AB45HVF	45	250	27.50	10000	1120
		AB50HVF	50	200	25.60	8000	1044

Further types made of cast concrete available on request.

Spacer with loop wire

WG: 185

	Description	Item No.	Concrete cover mm	Packaging unit Pcs	Weight kg/packaging unit	Pallet content Pcs	Weight kg/pallet
	For vertical and horizontal reinforcement, with galvanized eye wire	AB20HFOED	20	400	22.80	20000	1160
		AB25HFOED	25	250	18.25	15000	1115
		AB30HFOED	30	250	22.00	12500	1120
		AB35HFOED	35	250	26.25	10000	1070
		AB40HFOED	40	250	27.75	10000	1130
		AB45HFOED	45	200	25.40	8000	1036
		AB50HFOED	50	200	29.00	6000	890
		AB55HFOED	55	150	24.75	6000	1010
		AB60HFOED	60	150	43.20	6000	1748

Further types made of cast concrete available on request.

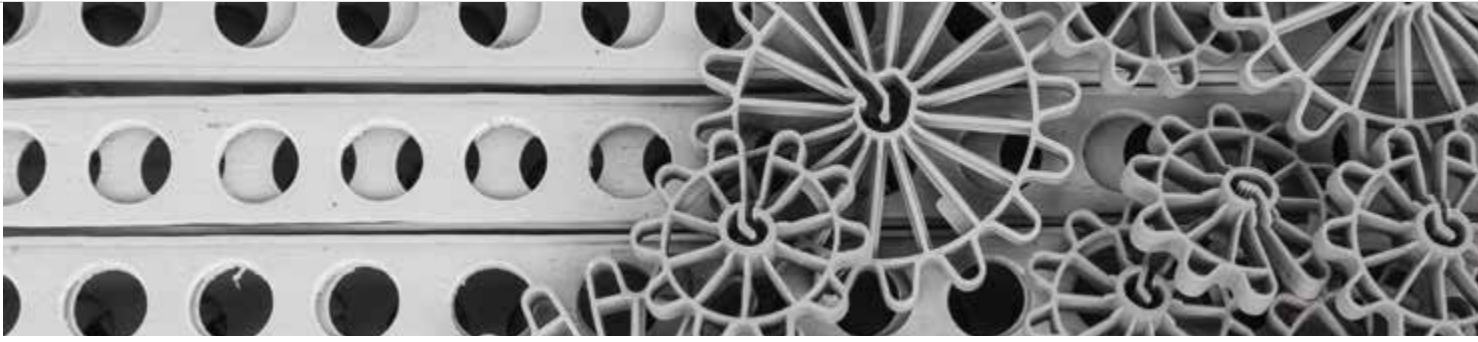

Plastic spacers

Spacers ensure the concrete cover before and during concreting. In the case of simple interior components, plastic spacers are a cost-effective alternative to the tried and tested fibre-reinforced concrete spacers and to spacers made of cast concrete.

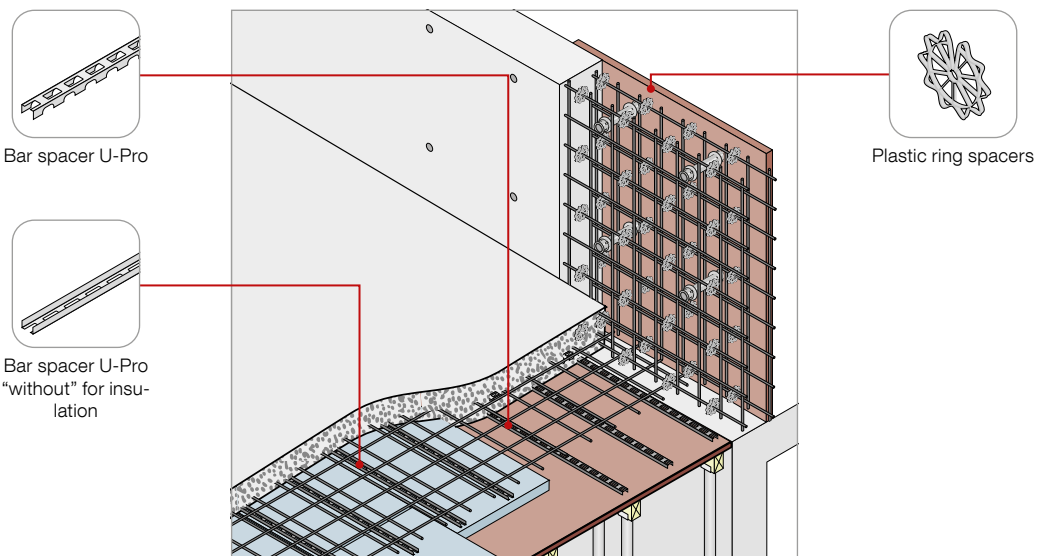

Plastic ring spacers



WG: 164

	Item No.	Concrete cover	For steel diameters	Packaging unit	Weight	Pallet content	Weight
		mm	mm	Pcs	kg/packaging unit	Pcs	kg/pallet
	KRA15	15	4 - 12	1000	2.80	60000	188
	KRA20	20	4 - 12	1000	4.00	50000	220
	KRA25	25	4 - 12	500	3.05	30000	203
	KRA30	30	4 - 12	500	4.70	20000	208
	KRA35	35	4 - 12	200	3.20	12000	212
	KRA40	40	4 - 12	125	2.16	10000	193
	KRA50	50	4 - 12	100	2.40	5000	140

Fractional quantities are not possible.

Plastic bar spacers

WG: 164

	Description	Item No.	Concrete cover	Length	Packaging unit	Weight	Pallet content	Weight
			mm	m	Pcs	kg/packaging unit	Pcs	kg/pallet
	U-Pro "with" – profiles with lateral recess	KUM20	20	2.00	50	14.00	3150	902
		KUM25	25	2.00	50	17.50	2450	878
		KUM30	30	2.00	50	21.50	2100	923
		KUM35	35	2.00	30	14.40	1800	884
		KUM40	40	2.00	30	15.30	1200	632
		KUM50	50	2.00	30	25.20	840	726
	U-Pro "without" – profiles for insulation	KUO25	25	2.00	50	20.50	2450	1025
		KUO30	30	2.00	50	24.00	2100	1028
		KUO35	35	2.00	30	15.90	1800	974
		KUO40	40	2.00	30	17.10	1200	704
		KUO50	50	2.00	30	30.30	840	868

Fractional quantities are not possible.

Plastic pipes

WG: 164





Round tube, roughened.

	Item No.	Internal diameter	External diameter	Length	Packaging unit	Weight	Pallet content
		mm	mm	m	Pcs	kg/packaging unit	Pcs
	KR2226	22	26	2.00	50	20.00	1750

Fractional quantities are not possible.

Plastic pipes components



WG: 164

	Description	Item No.	Suitable for	Installation length mm	Packaging unit Pcs	Weight kg/packaging unit	Pallet content Pcs
	Face cap for round tube, diameter 22 mm	KVK2240	KR2226	25	500	3.80	20000
	Sealing stopper for round tube and face cap	KVST22	KR2226, KVK2240	12	500	0.95	50000
	Inner plug for round tube sealing	KIST22	KR2226	25	500	5.00	50000
	Cone, grey, for round tube, diameter 22 mm	KKO22	KR2226	10	500	1.75	30000
	Sealing plug for round tube diameter 22 mm	KVST22L	MR22, MQUELLM	1	500	0.80	40000

Fractional quantities are not possible.

Plastic distance tubes

WG: 164

	Description	Item No.	Internal diameter mm	Length mm	Packaging unit Pcs	Pallet content Pcs
	Plastic distance tube incl. 2 sealing stoppers, in a stable execution with widened support for formwork	KMS200	22	200	100	3000
		KMS240	22	240	100	2400
		KMS250	22	250	100	2400
		KMS300	22	300	100	2400
		KMS400	22	400	100	1500
	Sealing stopper for the fast and secure sealing of the distance tubes	KMSV22	22	-	200	25000

Fractional quantities are not possible.



Steel spacers

Steel spacers are used between the lower and upper reinforcement in the floor, ceiling and wall. They ensure the spacing between the reinforcement layers. This type of spacer is ideally suited for installation of mats and steel bar reinforcements.

★ Advantages

- Tested according to DBV leaflet "Supports" according to Eurocode 2
- Large support area prevents tipping
- No contact with the formwork, therefore no damage to the formwork skin and no rust stain formation

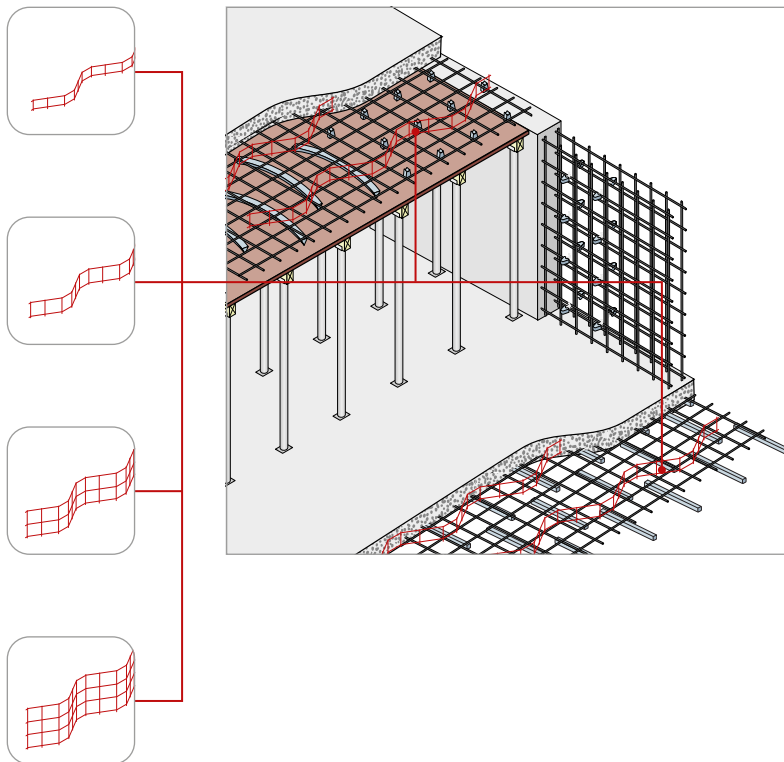

U-Korb®

WG: 72

Wire spacer for spacing the reinforcement in floor / ceiling / wall.

Item No.	Height	Description	Packaging unit	Pallet content	Weight kg/pallet
	mm		Pcs	Pcs	
UKS02	20	2/200	25	3000	1226
UKS03	30	3/200	25	2800	1188
UKS04	40	4/200	25	2600	1143
UKS05	50	5/200	25	2200	1003
UKS06	60	6/200	25	2000	944
UKS07	70	7/200	25	1600	783
UKS08	80	8/200	25	1600	807
UKS09	90	9/200	25	1400	730
UKS10	100	10/200	25	1200	646
UKS11	110	11/200	25	1200	664
UKS12	120	12/200	25	1000	571
UKS13	130	13/200	25	1000	649
UKS14	140	14/200	25	800	535
UKS15	150	15/200	25	800	547
UKS16	160	16/200	25	800	559
UKS18	180	18/200	25	600	510
UKS20	200	20/200	25	600	532
UKS22	220	22/200	25	600	606
UKS24	240	24/200	25	400	426
UKS26	260	26/200	25	400	458
UKS28	280	28/200	25	400	473
UKS30	300	30/200	25	400	488
UKS32	320	32/200	25	200	296
UKS34	340	34/200	25	200	303
UKS36	360	36/200	25	200	311
UKS38	380	38/200	25	200	318

DBV-h-B-L, comply with the requirements of the DBV data sheet "Support".
 Fractional quantities are not possible.
 Permissible load: 0.67kN/m.

Installation distance according to DBV leaflet "Supports according to Eurocode 2"

Diameter of supported bars	close space "distances"
$\varnothing \leq 6,5 \text{ mm}$	500 mm
$6,5 \text{ mm} < \varnothing \leq 12 \text{ mm}$	700 mm
$\varnothing > 12 \text{ mm}$	700 mm

The installation distance corresponds to the centre distance.
 Linear supports are to be butted in the longitudinal direction.
 If a larger installation distance is to be selected, this must be verified by a calculation.



Fibre concrete distance tubes

Distance tubes are used with reusable tie bars to guarantee the concrete walls thickness. They bond completely with the concrete and thus prevent the penetration of water and other concrete damaging substances. Distance tubes can be combined with accessories from MAX FRANK to create a proven system for a wide range of physical and chemical influences on structures. Certifications from certified testing centres are available.

Advantages

- Shutter ties designed for water-impermeable components
- Homogeneous bond created with structural concrete with the same material properties
- Proven system of individually matched components

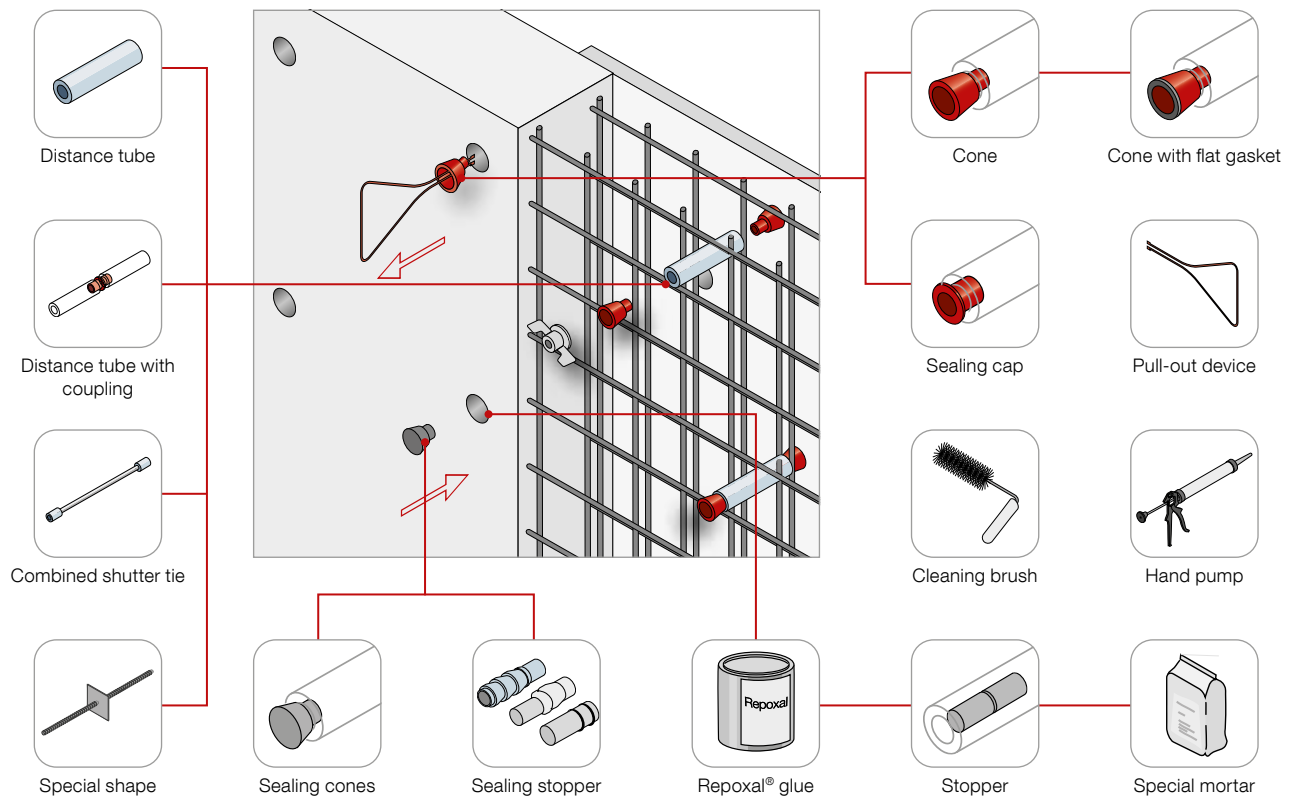

Selection table tie bar

Distance tube Ø [mm]	Tie bar Ø nominal dimension [mm]
22	12,5
22	15,0
27	20,0
32	22,0

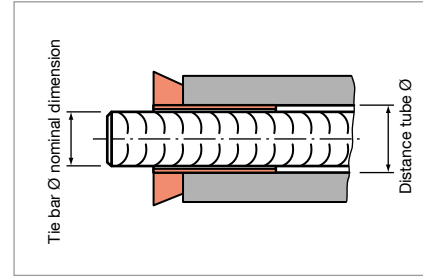
Distance tubes, uncut

WG: 58

Made of fibre-reinforced concrete.

Item No.	Internal diameter mm	Length m	Weight kg/m	Pallet content Pcs	Weight kg/pallet
MR221250	22	1.25	1.83	600	1393
MR271250	27	1.25	2.10	500	1333

Distance tubes, fixed lengths

WG: 58



Made of fibre-reinforced concrete.

Item No.	Length mm	Packaging unit Pcs	Weight kg/packaging unit	Pallet content Pcs	Weight kg/pallet
MR220100	100	200	37.60	4800	922
MR220120	120	120	27.36	4320	1005
MR220130	130	120	28.80	4320	1057
MR220140	140	120	31.68	4320	1160
MR220150	150	120	33.96	4320	1243
MR220160	160	100	30.30	3600	1111
MR220180	180	100	33.90	2400	834
MR220200	200	80	30.32	2880	1112
MR220210	210	70	30.52	2520	1119
MR220220	220	100	41.30	2400	1011
MR220230	230	70	30.52	2520	1119
MR220240	240	70	31.71	2520	1162
MR220250	250	70	32.97	2520	1207
MR220260	260	60	28.80	2160	1057
MR220270	270	60	30.60	2160	1122
MR220280	280	60	31.68	2160	1160
MR220300	300	60	33.90	2160	1240
MR220330	330	60	37.20	1440	913
MR220340	340	60	38.28	1440	939
MR220345	345	60	37.86	1440	929
MR220350	350	60	39.42	1440	966
MR220360	360	60	40.50	1440	992
MR220365	365	60	41.10	1440	1006
MR220380	380	60	42.72	1440	1045
MR220400	400	60	44.88	1440	1097
MR220430	430	40	31.48	1440	1153
MR220450	450	40	33.92	1440	1241
MR220480	480	40	35.60	1440	1302
MR220500	500	40	37.60	1440	1374

Any cut length up to 1.25 m can be supplied - item number MRFIX. All cut lengths below 100 mm are invoiced at the price of 100 mm. Fixed lengths for distance tubes diameter 27 mm on request.

Combined shutter ties

WG: 102

	Description	Item No.
	Combined shutter tie	V22VBS V27VBS
	Combined shutter tie with cast-iron waterstop and fibre-reinforced concrete pipes	V22WSG
	Combined shutter tie with cast-iron waterstop, fibre-reinforced concrete end pieces and steel pipes	V22WSGST

Delivery takes place in unassembled separate parts.

Distance tube with coupling

WG: 102

	Description	Item No.
	Two-part distance tube with coupler (continuous tie bar), from wall thickness > 400 mm	MR22KUP MR27KUP

Delivery takes place in unassembled separate parts.

Shutter ties, special versions

WG: 102

	Description	Item No.
	Waterstop, 120 x 120 x 2 mm, welded onto tie bar, diameter 15 mm, type B	GEWWSB15

Delivery takes place in unassembled separate parts.

Sealing cap, cone, coupling

WG: 98

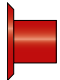
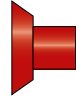
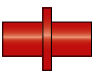
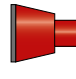
	Description	Item No.	For internal diameter mm	Installation length mm	Packaging unit	Outer packaging Pcs
					Pcs	
	Sealing cap	MKAP22	22	1	250	3750
		MKAP27	27	2	250	-
	Cone	MKO22	22	10	250	2500
		MKON22T	22	30	250	1000
		MKON22T50	22	50	250	-
		MKON27	27	10	250	2500
			Coupler	MKUP22 MKUP27	22 27	3 3
	Cone, incl. flat gasket 2 mm	MKO22FD02	22	10	250	-
	Cone, incl. flat gasket 8 mm	MKO22FD08	22	10	250	-
	Cone, incl. flat gasket 2 mm	MKON22TFD02	22	30	250	-
	Cone, incl. flat gasket 6 mm	MKON22TFD06	22	30	250	-

Flat gasket, self-adhesive

WG: 98

For preventing efflorescence, for exposed concrete requirements.

	Item No.	Suitable for	Internal diameter mm	External diameter mm	Thickness mm	Packaging unit Pcs
	MFD22	MKO22	20	36	2	100
	MFD2208	MKO22	20	36	8	100
	MFD22T	MKON22T, MKON22T50	25	39	2	100
	MFD22T06	MKON22T, MKON22T50	25	39	6	100
	MFD27	MKON27	24	45	2	100
	MFD2706	MKON27	24	45	6	100



Sealing cones and plugs

Formwork bracing leaves openings in the concrete wall after concreting and stripping. Fibre concrete sealing cones and plugs for straightforward sealing of tie holes. There are various seal versions, depending on the requirements with regard to appearance, building physics, weathering and construction. The stoppers and cones are glued using the tried-and-tested Repoxal®. This systems meets the requirements for sound insulation, fire protection and pressing water loads.

Advantages

- Fast and clean sealing of tie holes
- Individual design opportunities
- Watertight sealing of structures
- Smooth, almost pore-free concrete surface

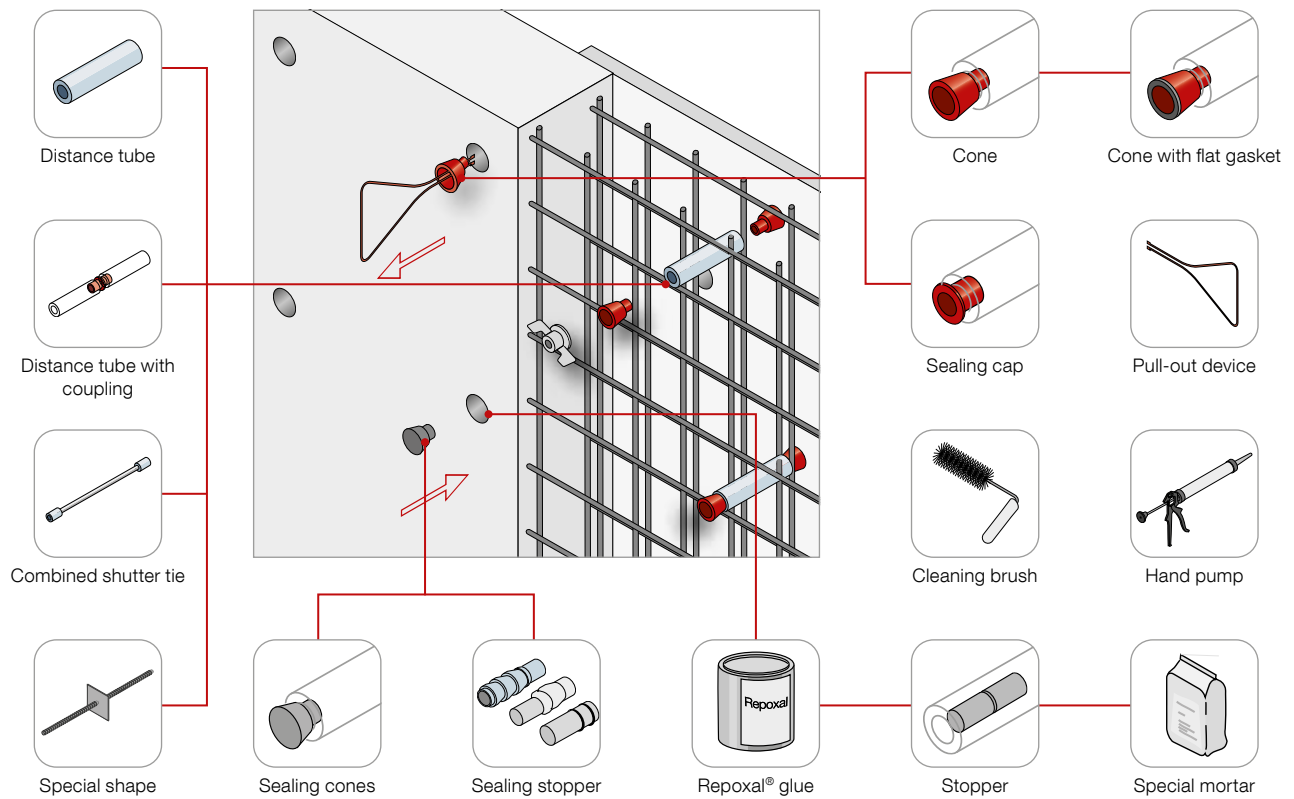

- ⊕ suitable
- conditionally suitable
- ⊖ not suitable

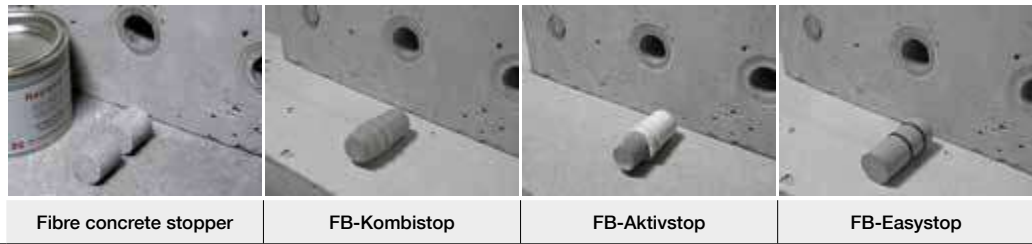

	Fibre concrete stopper	FB-Kombistop	FB-Aktivstop	FB-Easystop
Properties:				
Installation in frosty weather	⊖	⊕	⊕	⊕
Drinking water	⊕	⊕	⊖	⊖
Exposed concrete	○	⊖	⊖	⊕
Stress:				
Salt water	⊕	⊖	⊕	○
Slurry	⊕	⊖	⊕	⊖
Oil	⊖	⊖	○	⊕
Application area:				
Water-impermeable (> 5 bar)	⊕	⊕	⊕	⊖
Fire	⊕	⊖	⊖	⊖
Sound insulation	⊕	⊖	⊖	⊖
Processing:	Glue in	Simple tapping in with rubber hammer	Simple tapping in with rubber hammer	Simple screwing in by hand

Combination of sealing options

	Sealing cone with lugs, butted	Sealing cone with lugs, recessed	Sealing cone, butted	Sealing cone, recessed	Fibre concrete stopper	FB-Kombistop	FB-Aktivstop	FB-Easystop
	⊖	⊖	⊖	⊖	⊕	⊕	⊕	⊕
(10 mm)	FBVKZ22 GBVKZ22	GBVKZ22ZV05				ST2250FG	ST2250AS	ST2250ES
	⊕	⊕	⊖	⊖	⊕	⊕	⊕	⊕
(30 mm)	FBVKZ22T		FBVK22T GBVK22T	FBVK22TZV05 GBVK22TZV05				
	⊕	⊖	⊕	⊕	⊖	⊖	⊖	⊖
(50 mm)	FBVKZ22T50		FBVK22T50					
	⊕	⊖	⊕	⊖	⊖	⊖	⊖	⊖

Fibre concrete stopper

WG: 58

	Item No.	Diameter mm	Length mm	Packaging unit Pcs	Weight kg/packaging unit	Pallet content Pcs	Weight kg/pallet
		ST190020	19	20	1000	12.00	50000
	ST200020	20	20	1000	13.00	50000	670
	ST220020	22	20	1000	16.00	50000	820
	ST230020	23	20	1000	17.00	50000	870
	ST240020	24	20	1000	19.00	50000	970
	ST250020	25	20	1000	20.00	50000	1020
	ST260020	26	20	1000	24.00	50000	1220
	ST270020	27	20	1000	24.00	50000	1220
	ST220050	22	50	500	20.00	25000	1020
	ST270050	27	50	400	23.60	16000	964

Fibre concrete stoppers, uncut

WG: 58

Item No.	Diameter mm	Length mm	Pallet content Pcs	Weight kg/pallet
ST221250	22	1250	1250	1239

FB-Kombistop

WG: 128

Sealing stopper made of fibre-reinforced concrete with integrated rubber seal.

	Item No.	Diameter mm	Length mm	Packaging unit Pcs	Weight kg/packaging unit
		ST2250FG	22	50	100

FB-Aktivstop

WG: 128

Sealing stopper made of fibre-reinforced concrete with integrated expanding seal.

	Item No.	Diameter mm	Length mm	Packaging unit Pcs	Weight kg/packaging unit
		ST2250AS	22	50	100

FB-Easystop

WG: 128

Sealing stopper made of fibre-reinforced concrete with integrated sealing rings.

	Item No.	Diameter mm	Length mm	Packaging unit Pcs	Weight kg/packaging unit
		ST2250ES	22	50	100

FB-Aktivstop Platinum 100

WG: 128

Sealing stopper made of fibre-reinforced concrete for sealing the conical tie hole for formwork "Platinum 100".

	Item No.	Diameter	Length	Packaging unit	Weight
		mm	mm	Pcs	kg/package unit
	ST2250ASP	conical	60	100	3.15

Fibre-reinforced concrete sealing cones

WG: 128

For sealing conical tie holes and as a design element for exposed concrete surfaces.

	Description	Item No.	Suitable for	Dimensions	Packaging unit	Weight
				mm	Pcs	kg/package unit
	butted	FBVKZ22	MKO22	Ø41 x Ø21.6 x 22	100	3.00
		FBVKZ22T	MKON22T	Ø42.6 x Ø21.6 x 40	100	6.00
		FBVKZ22T50	MKON22T50	Ø42.6 x Ø21.6 x 60	100	16.00
		FBVKZ27	MKON27	Ø47 x Ø26.6 x 22	100	5.00
	set back 5 mm	FBVK22T	MKON22T	Ø42.9 x Ø31 x 28	100	6.00
		FBVK22T50	MKON22T50	Ø43 x Ø31 x 48	100	11.00
		FBVK22TZV05	MKON22T	Ø40.7 x Ø32 x 23	100	4.40
		FBVKSJK	GEWSKO15	Ø59 x Ø50 x 40	100	19.00
		butted, to fit steel/plastic cone GEWSKO15				

Custom order of other sizes and shapes on request, article number FBVKSONDER.

Special colours and shapes

The colour gradations 3H, 1H, Standard and 4D are available as basic colours for sealing cones made of fibre-reinforced concrete and cast concrete (see adjacent figure).

Based on these basic colours, a variety of other shades of grey are available for sealing cones. This also applies to other colours, such as reds, yellows or browns. A project-related colour match is required for this.

Colour accuracy cannot be guaranteed on account of fluctuations in the natural raw materials. Recessed variants are recommended, since the colour gradation is emphasised by the shadow joint of the geometric grid of the clamping points.

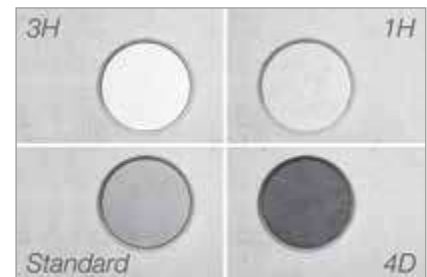

Cast concrete sealing cones



WG: 128

For sealing conical tie holes and as a design element for exposed concrete surfaces.

	Description	Item No.	Suitable for	Dimensions	Packaging unit	Weight
				mm	Pcs	kg/package unit
	butted	GBVKZ22	MKO22	Ø41 x Ø21.6 x 22	100	3.00
	set back 5 mm	GBVKZ22ZV05	MKO22	Ø33.5 x Ø21.6 x 22	100	2.00
	butted	GBVKZ27	MKON27	Ø47 x Ø26.6 x 22	100	5.00
		GBVK22T	MKON22T	Ø42.5 x Ø32 x 28	100	6.00
	set back 5 mm	GBVK22TZV05	MKON22T	Ø40.7 x Ø32 x 23	100	5.00

Adhesive

WG: 98

	Description	Item No.	Content	Packaging unit Pcs	Weight kg/packaging unit
	Repoxal® two-component glue (specially for impermeable bonding)	MREPOX	710 g + 290 g	10	10.00
	Repoxal® K adhesive incl. hardener in double cartridge	MREPOXK	2 x 310 ml	12	11.04
	Repoxal® TW two-component glue (tested for impermeable bonding in drinking water application)	MREPOXTW	500 g + 250 g	6	5.36

Coverage of Repoxal®, Repoxal® TW and Repoxal® K

- Consumption quantities: approx. 3 kg for 1,000 stoppers, length 20 mm, diameter 22 mm
- Consumption quantities: approx. 4 kg for 1,000 stoppers, length 20 mm, diameter 27 mm

Accessories

WG: 98

Description	Item No.
Hand pump for Repoxal® K double cartridge	MRKHPR
Cone pull-out device	MZGKONEN
Cleaning brush for distance tubes diameter 22 mm	MRBUERSTE
Cleaning brush for distance tubes diameter 22 mm with shoulder for drilling machine	MRBUERSTEAB
Static mixer Repoxal® cartridge adhesive, spare part	MREPOXK1
Static mixer Repoxal® 2-component cartridge adhesive, spare part	MREPOXK2

Special mortar

WG: 100

Swelling mortar – low-shrinkage cement-based mortar for filling combined shutter ties and for tamping concrete openings of all kinds.



	Description	Item No.	Weight kg/bag	Weight kg/pallet	Pallet content Packaging unit
	Special mortar 3/25	MQUELLM	25.00	1020	40

Processing:

- Depending on the temperature, pot life is approx. 40 minutes.
- Do not process at ambient, component and mortar temperatures below + 5 °C.
- You will need approx. 1 kg ready-mix mortar per metre of Ø 22 mm distance tube.

Hand pump

WG: 100

	Description	Item No.
	Hand pump	MQUELLVS
	Extension nozzle	MQUELLVSV

Further accessories and spare parts on request.
 Suitable sealing plug (KVST22L) see page 28.



Spacers and distance tubes for drinking water application

Drinking water is a particularly valuable commodity that must be protected. Therefore, special requirements and tests apply to products used in drinking water supply structures. In the DVGW worksheet W 300-1 (A) "Drinking Water Tanks - Design and Construction" a water-impermeable and low-porosity concrete is required that does not require any further measures for surface treatment and inner lining.

Advantages

- The MAX FRANK system solution (see system drawing) meets the requirements for drinking water supply systems.
- The sealing of the tie hole complies with the UBA guideline on epoxy resin coatings for the hygienic assessment of epoxy resin coatings in contact with drinking water.
- MAX FRANK TW spacers and TW distance tubes comply with the DVGW worksheet W 347 "Hygiene requirements for cement-bound materials intended for use in drinking water supply systems". The KTW test (migration test) applies to cement-bound materials such as fibre-reinforced concrete.
- MAX FRANK TW spacers and TW distance tubes comply with the DVGW worksheet W 270 "Microbial enhancement on materials to come into contact with drinking water".

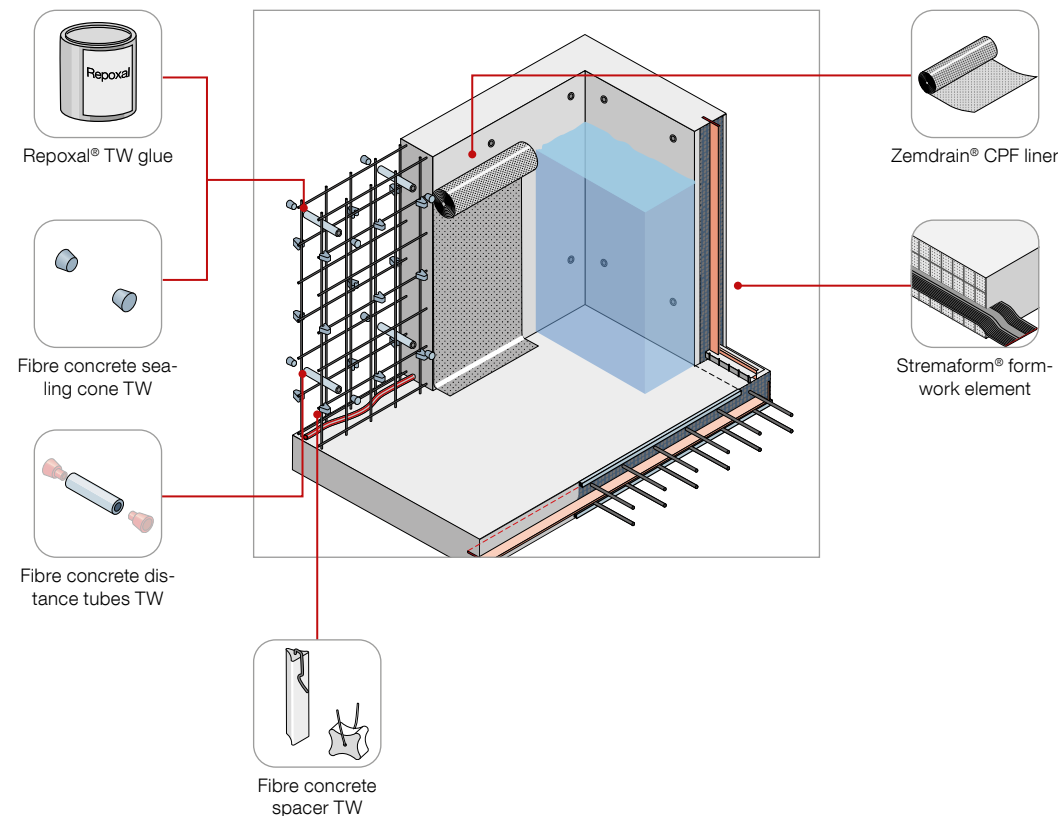

Block spacer made of fibre-reinforced concrete TW

WG: 99

Tested according to DVGW-W270 and DVGW-W347.

	Item No.	Concrete cover	Cutting width	Packaging unit	Weight	Pallet content	Weight
		mm	mm	Pcs	kg/packaging unit	Pcs	kg/pallet
	AD3572TW	35/40/50	24	250	24.00	10000	980

Bar spacer made of fibre-reinforced concrete TW - type "snake"

WG: 99

	Item No.	Concrete cover	Length	Weight	Pallet content	Weight
		mm	mm	kg/pce	Pcs	kg/pallet
	FAHKS40100TW	40	1000	1.27	600	782
	FAHKS45100TW	45	1000	1.41	500	725
	FAHKS50100TW	50	1000	1.74	500	890

Lengths can be subject to production-related tolerance.

Bar spacer made of fibre-reinforced concrete TW - type triangular with hook

WG: 99

	Item No.	Concrete cover	Length	Packaging unit	Weight	Pallet content	Weight
		mm	mm	Pcs	kg/packaging unit	Pcs	kg/pallet
	FAHDH40018TW	40	180	75	19.43	1800	486
	FAHDH50018TW	50	180	50	22.90	1200	570

Lengths can be subject to production-related tolerance.

Fibre-reinforced concrete distance tube TW, uncut

WG: 99

Item No.	Internal diameter	Length	Weight	Pallet content	Weight
	mm	m	kg/pce	Pcs	kg/pallet
MR221250TW	22	1.25	2.29	600	1393

Fibre-reinforced concrete distance tube TW, standard lengths

WG: 99

Item No.	Internal diameter	Length	Weight	Pallet content	Weight
	mm	mm	kg/pce	Pcs	kg/pallet
MR220280TW	22	280	0.53	2160	1160
MR220300TW	22	300	0.57	2160	1240

Other fixed lengths on request.

Stopper made of fibre-reinforced concrete TW

WG: 99

Item No.	Diameter	Length	Packaging unit	Weight	Pallet content	Weight
	mm	mm	Pcs	kg/packaging unit	Pcs	kg/pallet
ST220020TW	22	20	1000	16.00	50000	820

Fibre-reinforced concrete sealing cone TW

WG: 99

For sealing conical tie holes.

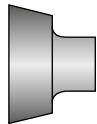
	Description	Item No.	Suitable for	Dimensions	Packaging unit	Weight
				mm	Pcs	kg/packaging unit
	buted	FBVKZ22TW	MKO22	Ø41 x Ø21.6 x 22	100	3.00
		FBVKZ22TTW	MKON22T	Ø42.6 x Ø21.6 x 40	100	6.00

Custom-made products on request.

Repoxal® TW two-component glue

WG: 99

	Description	Item No.	Content	Packaging unit Pcs	Weight kg/packaging unit
	Repoxal® TW two-component glue (tested for impermeable bonding in drinking water application)	MREPOXTW	500 g + 250 g	6	5.36

For yield, see page 39.



**BUILDING
COMMON GROUND**



MAX FRANK Group

Headquarters:

Max Frank GmbH & Co. KG

Mitterweg 1

94339 Leiblfing

Germany

www.maxfrank.com

